

## Microsoft Modern Authentication eeldused Merit Palgas

Merit Palk E-posti seadistustes, kui saatmisviisiks on valitud Exchange Modern Auth, on näha järgmised read, mis tuleb täita Microsoft Azure Active Directorys loodud Aplikatsiooni andmetega:

Üldised seadistused / E-posti seadistused

Kirjade saatmise viis	Saatja e-posti aadress
Exchange Modern Auth	<input type="text" value="Kirja saatja e-posti aadress"/>
Server	Koopia
outlook.office365.com <small>MS serveri nimi, tavaliselt kõigil teenuse kasutajatel sama</small>	<input type="text"/>
Kliendi/Rakenduse ID	
20fb9e2d- <small>Teie jaoks loodud application ID</small>	
Tenant ID	
69777ef8- <small>Teie ettevõtte MS subscriptioni ID</small>	
Exchange kasutaja	
<input type="text" value="Kirja saatja (kasutaja) e-posti aadress"/>	
Kliendi salasõna	
<input type="password" value="....."/> <small>Applicatoni juurde loodud secret</small>	

Salvesta

Aplikatsiooni enda loomiseks peate oma Office365 keskkonda sisse logima administraatori õigustes kasutajaga ja liikuma „Haldus“->“Kuva kõik“. Sealt leiate „Azure Active Directory“

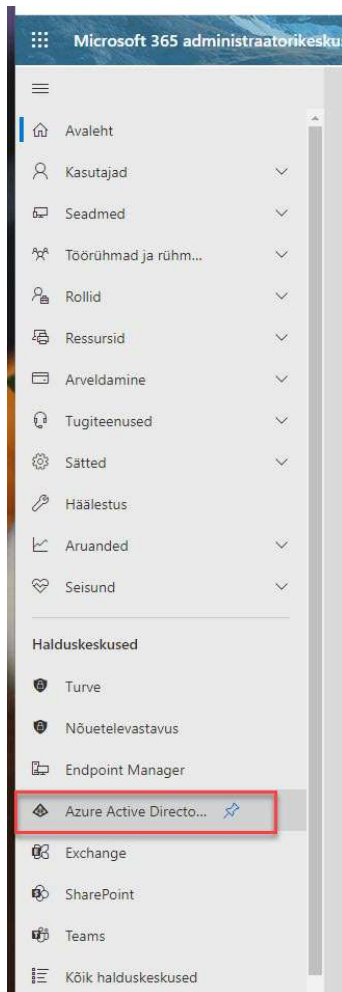

Kui te olete saanud siseneda oma Azure keskkonda, peaks teile olema koheselt leitav esimene ID, mida teil on tarvis kasutada Palgas, Directory (tenant) ID:

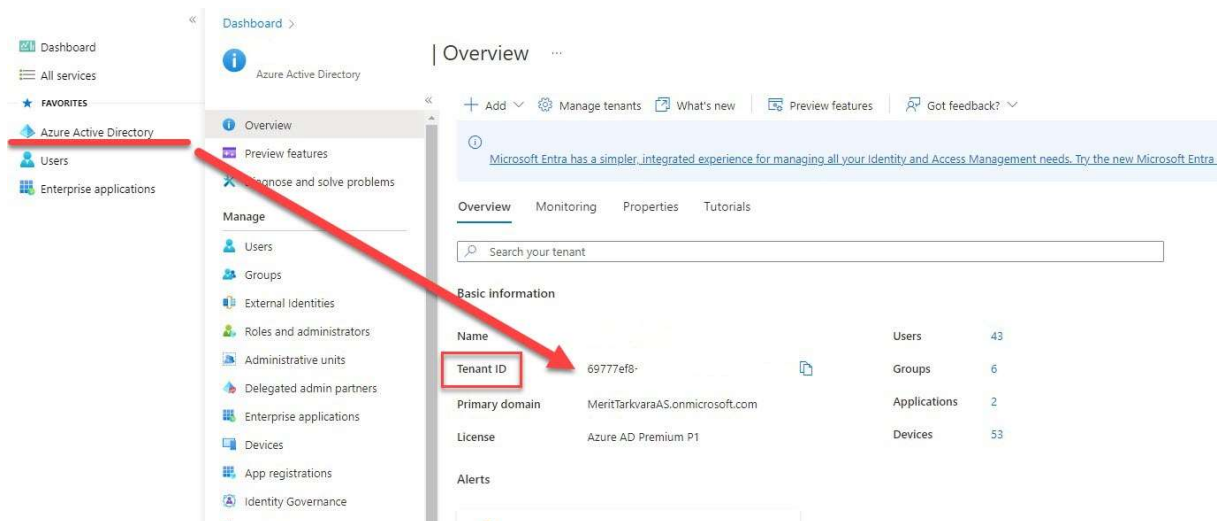

Järgmiseks tuleb luua Aplikatsioon, mille kaudu kirjad liikuma hakkavad, sellele Aplikatsioonile tuleb anda õigused ja luua Secret(id):

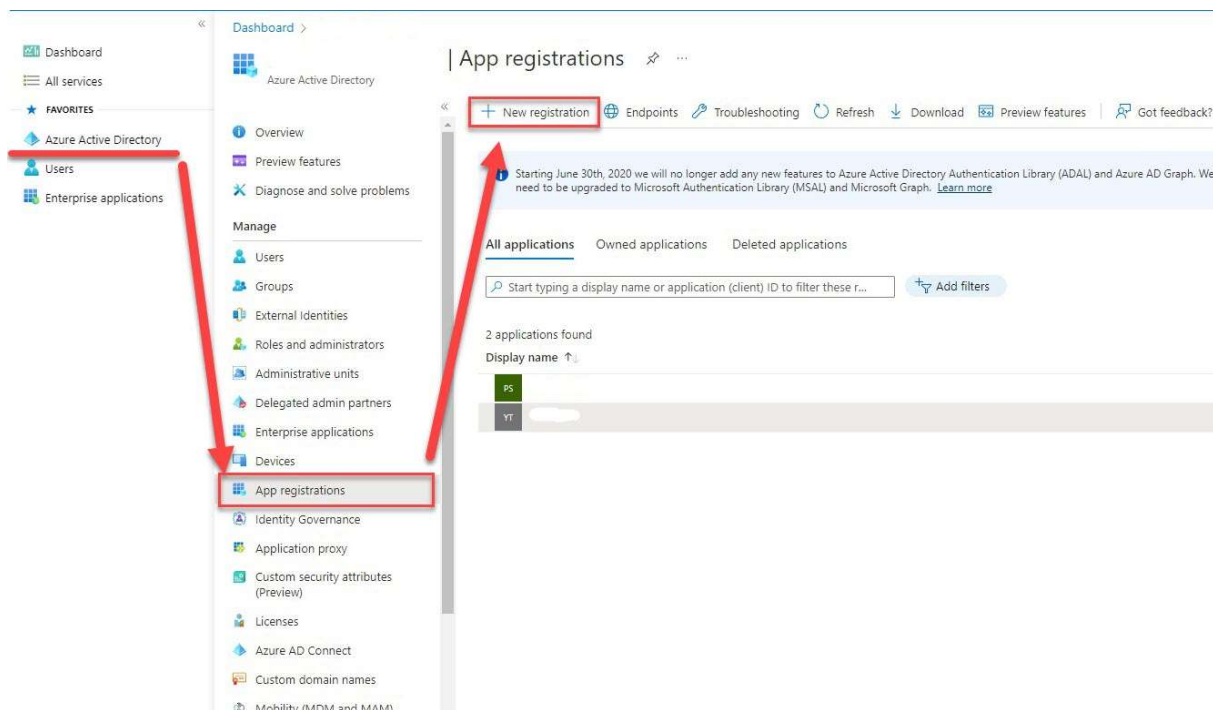

Tõenäoliselt loote te Aplikatsiooni ainult oma ettevõttele (ühele domeenile), seega peaks kasutama „Single Tenant“ valikut:

## Register an application

### \* Name

The user-facing display name for this application (this can be changed later).

Anna oma äpile nimi

### Supported account types

Who can use this application or access this API?

- Accounts in this organizational directory only (only - Single tenant)
- Accounts in any organizational directory (Any Azure AD directory - Multitenant)
- Accounts in any organizational directory (Any Azure AD directory - Multitenant) and personal Microsoft accounts (e.g. Skype, Xbox)
- Personal Microsoft accounts only

[Help me choose...](#)

### Redirect URI (optional)

We'll return the authentication response to this URI after successfully authenticating the user. Providing this now is optional and it can be changed later, but a value is required for most authentication scenarios.

Select a platform ▼ e.g. https://example.com/auth

Kui Aplikatsioon on loodud, on teil olemas järgmise välja väärtus Palgas, Kliendi/Rakenduse ID (number 1), Number 2 tähistab kohta, kus te saate luua omale Palga välja „Kliendi salasõna“ ja number 3 tähistab kohta, kus te peate looma omale antud Aplikatsiooni õigused:

Search ◀ Delete Endpoints Preview features

Got a second? We would love your feedback on Microsoft identity platform (previously Azure AD for developer). →

Essentials

Display name :  
Application (client) ID : 20fb9e2d- 1  
Object ID :  
Directory (tenant) ID :  
Supported account types : My organization only

Client credentials : 0.certificate\_2.secret 2  
Redirect URIs : Add a Redirect URI  
Application ID URI : Add an Application ID URI  
Managed application in I... :

Starting June 30th, 2020 we will no longer add any new features to Azure Active Directory Authentication Library (ADAL) and Azure AD Graph. We will continue to provide technical support and security updates but we will Applications will need to be upgraded to Microsoft Authentication Library (MSAL) and Microsoft Graph. [Learn more](#)

Get Started Documentation

### Build your application with the Microsoft identity platform

The Microsoft identity platform is an authentication service, open-source libraries, and application management tools. You can create modern, standards-based authentic solutions, access and protect APIs, and add sign-in for your users and customers. [Learn more](#)

Cloud, Network, Security, and Identity icons

## API õigused:

Klikka **API Permission** -> **Microsoft Graph** -> **Delegated Permission** -> **User.Read**.

Klikka **API Permission** -> **Microsoft Graph** -> **Application Permission** -> **Mail.Send**.

Klikka **API Permission** -> **Add a permission** -> **APIs in my organization uses** -

> **Office 365 Exchange Online** -> **Application Permission** -

> **Other permission** -> **full\_access\_as\_app**

Kui kasutaja, millega te loote õiguseid, ei ole kasutaja antud domeenis, ei leia te „Office 365 Exchange Online“ õiguste nimekirjast ja peate selle lisama käsitsi.

Search Refresh Got feedback?

Overview Quickstart Integration assistant

Manage

- Branding & properties
- Authentication
- Certificates & secrets
- Token configuration
- API permissions**
- Expose an API
- App roles
- Owners
- Roles and administrators
- Manifest

Support + Troubleshooting

- Troubleshooting
- New support request

The "Admin consent required" column shows the default value for an organization. However, user consent can be customized per permission, u

### Configured permissions

Applications are authorized to call APIs when they are granted permissions by users/admins as part of the consent process. The list of confi all the permissions the application needs. [Learn more about permissions and consent](#)

**+ Add a permission**  Grant admin consent for

API / Permissions name	Type	Description	Admin consent requ...
Microsoft Graph (3)			
Mail.Send	Delegated	Send mail as a user	No
Mail.Send	Application	Send mail as any user	Yes
User.Read	Delegated	Sign in and read user profile	No
Office 365 Exchange Online (1)			
full_access_as_app	Application	Use Exchange Web Services with full access to all mailboxes	Yes

To view and manage consented permissions for individual apps, as well as your tenant's consent settings, try [Enterprise applications](#).

Lisaks tuleb teha „grant admin consent“, kuna 2 meie õigustest nõuavad seda:

**+ Add a permission**  Grant admin consent for

API / Permissions name	Type	Description	Admin consent requ...	Status
Microsoft Graph (2)				
Mail.Send	Application	Send mail as any user	Yes	Granted for i ...
User.Read	Delegated	Sign in and read user profile	No	Granted for ...
Office 365 Exchange Online (1)				
full_access_as_app	Application	Use Exchange Web Services with full access to all mailboxes	Yes	Granted for . ...

Certificates & secrets

Search

Got feedback?

Overview

Quickstart

Integration assistant

Manage

Branding & properties

Authentication

Certificates & secrets

Token configuration

API permissions

Expose an API

App roles

Owners

Roles and administrators

Manifest

Support + Troubleshooting

Troubleshooting

New support request

Credentials enable confidential applications to identify themselves to the authentication service when receiving tokens at a web addressable location (using an HTTPS scheme). For a higher level of assurance, we recommend using a certificate (instead of a client secret) as a credential.

Application registration certificates, secrets and federated credentials can be found in the tabs below.

Certificates (0) Client secrets (2) Federated credentials (0)

A secret string that the application uses to prove its identity when requesting a token. Also can be referred to as application password.

+ New client secret

Description	Expires	Value	Secret ID
	4/10/2023	*****	b7b27446-
	10/4/2023	*****	3423cb17-

Secret(id) saate siis luua eelpool näidatud kohas ja Palka on tarvis kopeerida just „Value“ lahtrisse toodud informatsioon. Igale kasutajale võib luua eraldi secreti, kel on tarvis kasutada seda, aga piisab ühestainsast kõigile.

Kui see kõik on tehtud, võiks teie Modern Auth saatmisviis ka tööle hakata.

Võimalikud Veateated:

Kui rakenduse ID on vale: „(400) Bad Request“

Kui Tenant ID on vale: „is not avalid for TenantId“

Kui serveri nimi on valesti: „(400) bad Request“

Vale secret: „(401) Unauthorized“

Vale kasutajanimi: „(500) Internal Server Error“